

L0250HPGD

Features

- * 5.0mm x 2.0mm x 7.0 Square LED lamp
- * Low power requirement
- * I. C. Compatible
- * Easy assembly
- * RoHs compliant
- * Wide viewing angle
- * Bicolour version available

| Part No. | Chip | | Lens |
|-----------|--------------|----------------|----------|
| | Ram Material | Emitted colour | |
| L0250HPGD | InGaN | Pure Green | Diffused |
| | | | |

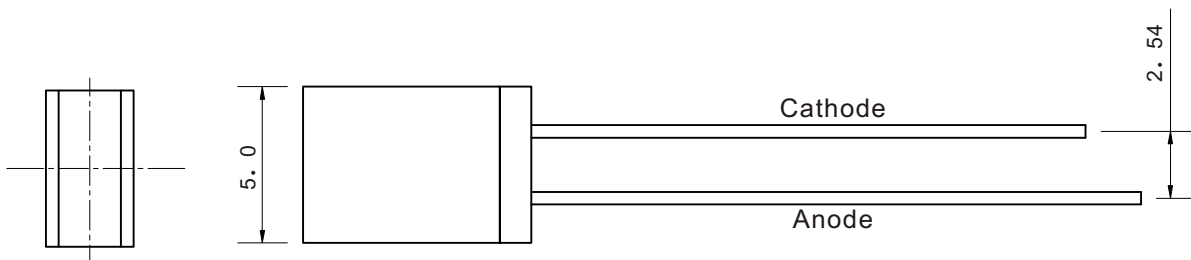
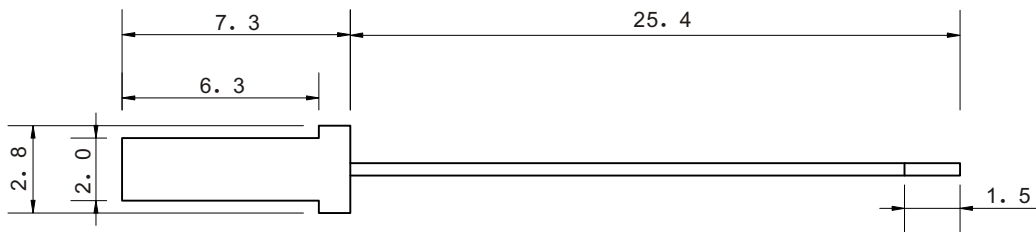

NOTES: 1. All dimensions are in millimeter (inches), tolerance is 0.25 unless otherwise noted.
2. Specifications are subject to change without notice.

Absolute Maximum Rating: (TA=25°C)

| Parameter | Symbol | Maximum Rating | Unit |
|-------------------------|-------------------|----------------|------|
| Peak Forward Current | IFp | 100 | mA |
| Forward Current | IF | 20 | mA |
| Reverse Voltage | VR | 5 | V |
| Power Dissipation | PD | 62 | mW |
| Operating Temperature | Topr | -40~+85 | °C |
| Storage Temperature | Tstg | -40~+85 | °C |
| Electrostatic Discharge | ESD | 500 | V |
| Soldering Temperature | 260°C for seconds | | |

Lead soldering Temperature (4mm from body) : 260°C for seconds

Optical-Electrical Characteristic: (TA=25°C)

| Parameter | Symbol | Condition | Min | Type | Max | Unit |
|---------------------|----------------|-----------|-----|------|-----|------|
| Forward Current | VF | IF=20mA | 3.0 | - | 3.6 | V |
| Reverse Current | IR | VR=5V | | - | 5 | uA |
| Dominant Wavelength | λ_d | IF=20mA | | | 525 | nm |
| Peak Wavelength | λ_p | IF=20mA | 520 | 522 | 525 | nm |
| Luminous Intensity | Iv | IF=20mA | 80 | - | 120 | mcd |
| Viewing Angle | 2 θ 1/2 | IF=20mA | - | 160 | - | Deg |

Fig. 1

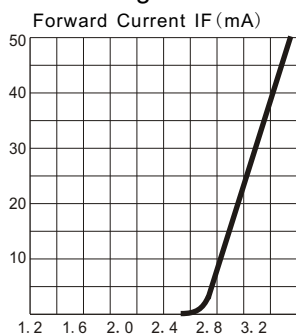

Forward Current VS
Forward Voltage .

Fig. 2

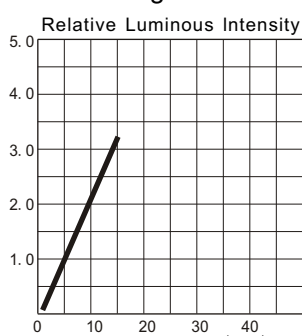

Relative Luminous Intensity
VS. Forward Current

Fig. 3

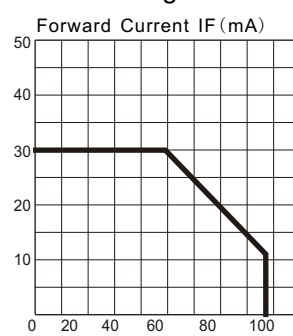

Ambient °C
Temperature Ta (°C)

Fig. 4

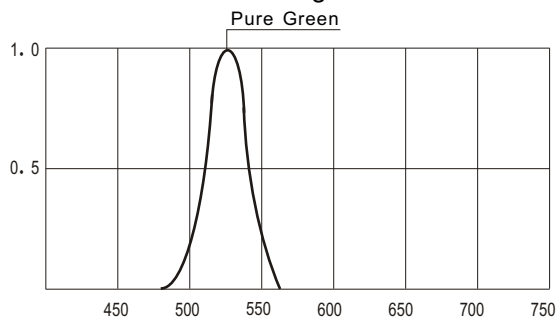

Relative Intensity vs. Wavelength

Fig. 5

